

Parts Diagram

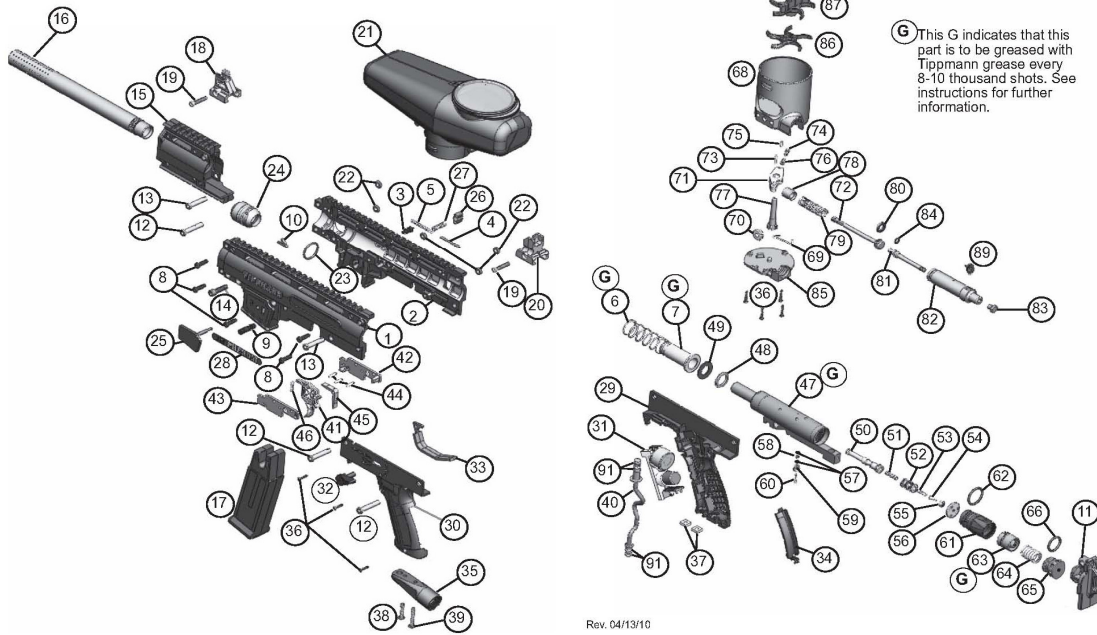

Rev. 04/13/10

Phenom Marker Parts List

ITEM	QTY.	PT. NO.	DESCRIPTION	ITEM	QTY.	PT. NO.	DESCRIPTION
1	1	TA30043	Receiver, Left Half	46	1	02-88	Compression Spring
2	1	TA30044	Receiver, Right Half	47	1	TA30024	Valve Body, Machined
3	1	TA30027	CFS Hose Fitting Assembly	48	1	TA30018	Spacer Washer
4	1	TA05016	Hose, 5/16" ID x 1 1/2"	49	1	TA20077	Bumper Disk
5	1	TA30057	Compression Spring	50	1	TA30038	Firing Spool Complete
6	1	TA30003	Compression Spring	51	1	TA30030	Compression Spring
7	1	TA30101	Front Bolt Assembly	52	1	TA30020	Valve Spool Spacer Complete
8	5	98-01A	Screw, LSHCS	53	1	02-88	Compression Spring
9	1	TA30016	Pressure Gauge Plug Assembly	54	1	TA30028	Regulator Pin
10	1	FA-18	Ball Latch	55	1	TA20075	Regulator Pin Seal
11	1	TA10038	End Cap	56	1	TA30025	Regulator Seat
12	3	TA10045	Push Pin Assembly	57	2	TA20008	O-Ring, C.U., 70A, 2-003
13	2	02-PIN	Push Pin Assembly	58	1	TA30036	Valve Core
14	1	02-41	1/4 - 20 UNC x" SHCS	59	1	TA30037	Trigger Pin Plug
15	1	TA30047	Front Grip/Shroud Assembly	60	1	TA30039	Trigger Pin
16	1	TA30041	Barrel	61	1	TA30026	Regulator Body
17	1	TA30004	Magazine	62	1	TA30040	O-ring
18	1	TA06061	Front Sight Assembly	63	1	TA30104	Regulator Piston Assembly
19	2	TA07065	Bolt	64	1	TA30031	Compression Spring
20	1	TA06041	Rear Sight Assembly	65	1	TA30022	Velocity Adjuster
21	1	TA10042	Hopper Assembly	66	1	TA30054	O-ring
22	5	9-PA	Hex Nut, Black	67	1	TA30046	Cyclone Feed System Assembly Complete
23	1	TA20046	O-ring	68	1	02-43	Feeder Housing
24	1	02-69	Barrel Adapter Assembly	69	1	02-50	Feeder Ratchet Spring
25	1	TA30006	Magazine Release Pin	70	1	02-42	1/4 - 20 Flange Nut
26	1	TA30009	Magazine Release Button	71	1	02-53	Feeder Ratchet
27	1	TA30032	Compression Spring	72	1	02-54	Feeder Cylinder Piston
28	1	TA30042	Name Plate	73	1	02-52L	Dowel Pin, 3/32 OD x 7/16"
29	1	TA30002	Lower Receiver, Right (Electro-pneumatic model)	74	1	TA01260	Compression Spring
29	1	TA30061	Lower Receiver, Right (Mechanical model)	75	1	02-52S	Dowel Pin, 3/32 OD x 5/16"
30	1	TA30001	Lower Receiver, Left (Electro-pneumatic model)	76	1	02-51	Ratchet Spring Guide
30	1	TA30060	Lower Receiver, Left (Mechanical model)	77	1	02-49	Feeder Axle
31	1	TA99600	Hall Effect Electronics	78	1	02-64	Feeder Cylinder Plug
32	1	TA30103	Selector Switch	79	1	02-66	Compression Spring
33	1	02-38	Trigger Guard	80	1	02-63	Piston U-Cup Seal
34	1	TA10066	Battery Door	81	1	02-65	Feeder Reset Rod
35	1	TA30015	Air Supply Adapter (ASA)	82	1	TA10034	Feeder Cylinder
36	9	PL-42A	Screw, #4 x 5/8" Black	83	1	02-61	Feeder Reset Button
37	2	CA-08B	Nut, 10-32 Square MS	84	1	SL2-6	O-Ring
38	1	PL-01A	Screw, BHCS	85	1	02-44	Feeder Bottom Plate
39	1	98-06A	Screw, BHCS	86	1	TA30012	Lower Feeder Sprocket
40	1	TA30045	Gas Line Assembly	87	1	TA30011	Upper Feeder Sprocket
41	1	TA30100	Trigger Assembly	88	1	02-48	#4 Flat Washer
42	1	TA30008	Trigger Plate, Right	89	1	20-07	Banjo Fitting Assembly
43	1	TA30007	Trigger Plate, Left	90	1	TA99004	9V Battery
44	3	02-33	Dowel Pin,	91	4	TA30049	O-Ring, Gas Line
45	1	TA30013	Trigger Lever				